

**Focus on Earthing**



**T<sup>e</sup>-BAR**

Earth Bonding System  
Earth Bonding System

# T<sup>e</sup>-BAR

## Earth Bonding System Earth Bonding System



- Simple to Install
- Innovative Design
- Economical Prices
- Available off-the-shelf
- Many Connection Options

The unique T<sup>e</sup>BAR insulator design supports twin tinned copper conductors which can have take-off connections installed at any point along its length. Simple installation of the overall assembly has been achieved without the need for additional mounting plates or rails.

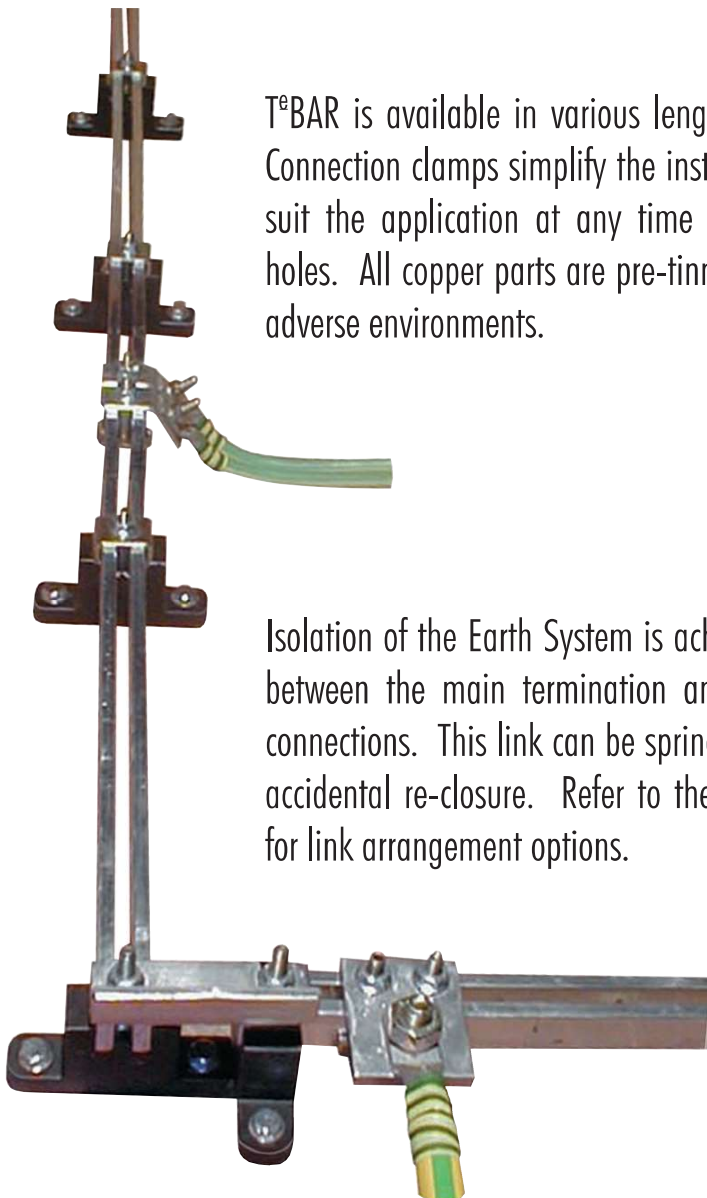

T<sup>e</sup>BAR is available in various lengths and ratings in order to suit most applications. Connection clamps simplify the installation of cables or braids and may be installed to suit the application at any time without disturbing existing connections or drilling holes. All copper parts are pre-tinned and fixings are electroplated for protection from adverse environments.

Isolation of the Earth System is achieved by a swing-link between the main termination and secondary bonding connections. This link can be spring assisted to eliminate accidental re-closure. Refer to the "Installation Details" for link arrangement options.

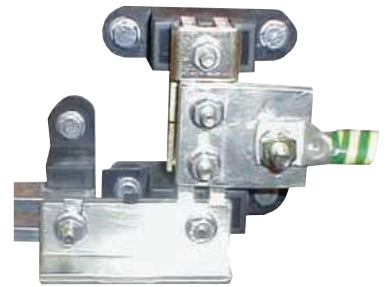

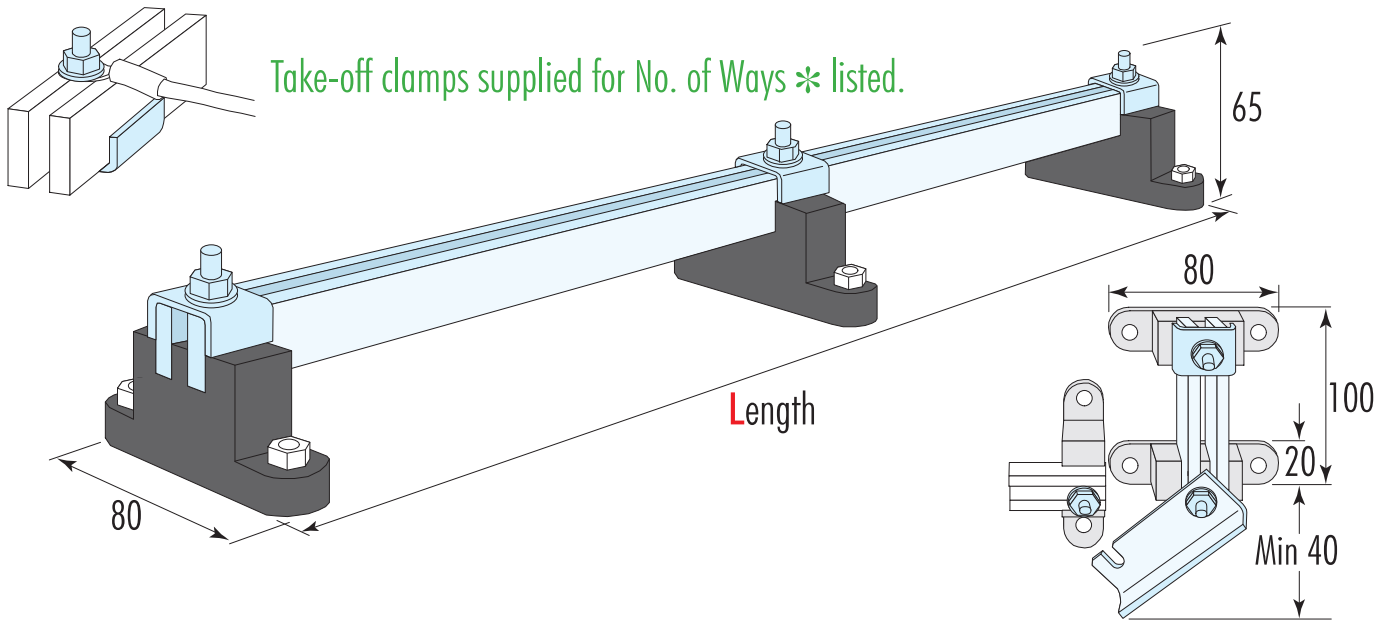

ASSEMBLY PART No.	RATING	No. of WAYS *	WEIGHT (gross) Kg	DIM L
<b>TE19/10</b>	600A	10	0.9	250
<b>TE19/20</b>	600A	20	1.8	480
<b>TE19/30</b>	600A	30	2.5	690
<b>TE19/40</b>	600A	40	3.4	920
<b>TE19/50</b>	600A	50	4.1	1130

ASSEMBLY PART No.	RATING	No. of WAYS *	WEIGHT (gross) Kg	DIM L
<b>TE25/10</b>	800A	10	1.1	250
<b>TE25/20</b>	800A	20	2.2	480
<b>TE25/30</b>	800A	30	3.0	690
<b>TE25/40</b>	800A	40	4.1	920
<b>TE25/50</b>	800A	50	5.0	1130

## ACCESSORIES

Pt. No. **TCB8**  
800A Connector

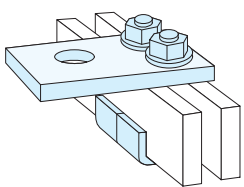

Pt. No. **TCB3**  
300A Connector

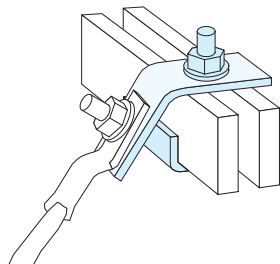

Pt. No. **TCB**  
Take-off/fixing clamps

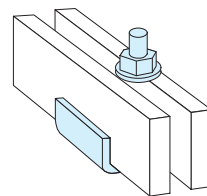

(Supplied in packs of 5)

Pt. No. **TE19/SLK** (600A)  
Pt. No. **TE25/SLK** (800A)

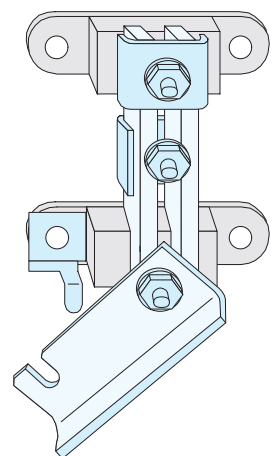

DISCONNECT LINK ASSEMBLY  
(with spring)

Pt. No. **TSLK**  
Swing Link

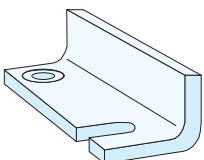

Pt. No. **TFPL**  
Joining Fishplate

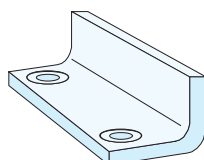

## TECHNICAL DATA

### Insulator

Black Polyamide Thermoplastic

Flammability - UL94-V0

NFF16-101/102 I<sup>3</sup>/F<sup>2</sup>

Oxygen Index - 36%

### Conductors

Material - HDHC Copper C101 to BS1432

Acid Tinning to BS1872

Halogen Free

Low Smoke

Service Temperature - 100 °C

CTI - 600V

### Impulse Withstand Voltage

(service entrance level)

> 12kV @ 1.2/50 s

## INSTALLATION

Wall fixing kit Pt. No. TFIX-W

(Kit contains 10 off M6 x 35 Coach Screws & plastic wall plugs)

For further information refer to Installation Details

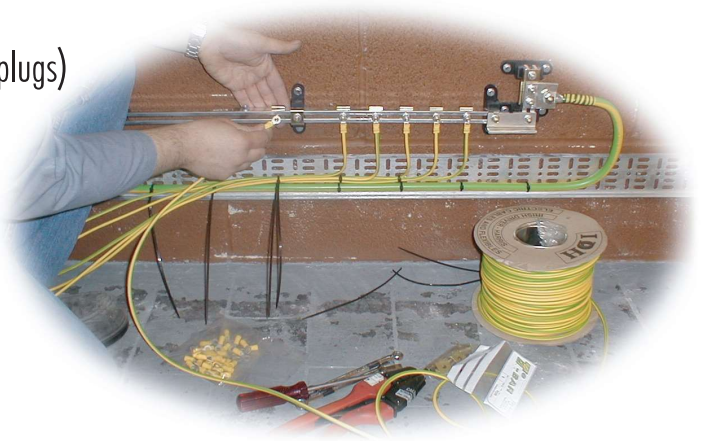

### Max. Tightening Torques

TFIX-W Wall Fixings

4Nm

M6 Connection & Insulator Screw

7Nm

M8 Incoming Connection

23 - 25Nm

All thermal ratings have been verified through extensive temperature rise testing. T°BAR is capable of withstanding the thermal effects of a 30kA for 1 second short circuit fault.



Standard and specialist braids and connections are available to complement the T°BAR system.

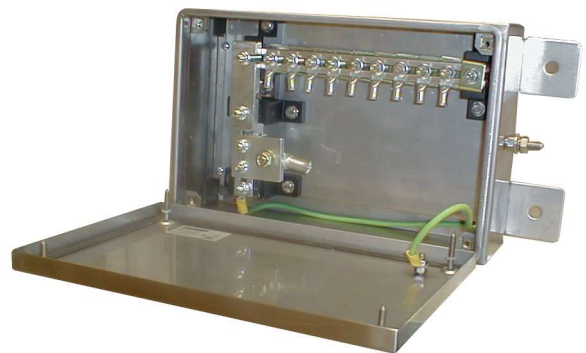

A specialist application comprising a Type Tested IP66 enclosed earthing system with link disconnect facility.



Leone Works, John Street, New Basford, Nottingham. NG7 7HL

Tel: 0115 978 4652 Fax: 0115 970 2106

email: [sales@termate.com](mailto:sales@termate.com) website: [www.termate.com](http://www.termate.com)