

Stand-off Insulators
Stand-off Insulators

<p>'SH' TYPE</p>		<p>2</p>
<p>'SO' TYPE</p>		<p>6</p>
<p>'S' TYPE</p>		<p>9</p>
<p>LOW SMOKE</p>		<p>14</p>
<p>PILLAR TYPE</p>		<p>16</p>
<p>CYGNUS</p>		<p>22, 23</p>
<p>10kV INSULATOR</p>		<p>27</p>

SHATTERPROOF HEXAGONAL

25 to 60mm HIGH

M6 THREADS

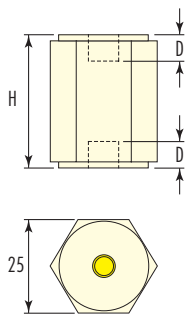

INSULATORS 'SH' TYPE



Base Material : Glass Fibre Reinforced Polyester DMC
with High Arc Resistance and
Reduced Flammability

Colour : Beige

Working Temperature : 160 °C

Oxygen Index : 30% to ISO 4589

UL Approval : UL94 - V0

Insert Material : Female - Brass

Thread : Isometric medium fit coarse thread
class 6H/6g

CTI : > 600V to BS5901

Nominal Working Voltage (Ue) : 440V

Nominal Insulation Voltage (Ui) : 690V

Maximum Tightening Torque : 7Nm

Related Parts : SH6...H

See Page 4

Pt. No.	Height H-mm	Thread Size	Thread Depth D-mm
* SH625	25	M6	7
SH630	30	M6	7
SH635	35	M6	7
SH640	40	M6	7
SH645	45	M6	7
SH650	50	M6	7
SH660	60	M6	7

SH680	80	M6	7
SH6100	100	M6	7

Please contact our Technical Department for availability of these, or any other, non-standard insulators.

* Also available in Low Smoke material, see Page 14 for more information

See Pages 24 - 26
for Technical Data

INSULATORS 'SH' TYPE

SHATTERPROOF HEXAGONAL

30 to 60mm HIGH

M8 THREADS

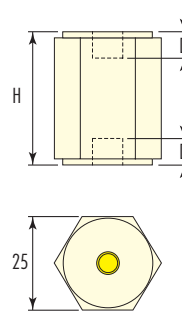

Base Material : Glass Fibre Reinforced Polyester DMC
with High Arc Resistance and
Reduced Flammability

Colour : Beige

Working Temperature : 160°C

Oxygen Index : 30% to ISO 4589

UL Approval : UL94 - V0

Insert Material : Female - Brass

Thread : Isometric medium fit coarse thread
class 6H/6g

CTI : >600V to BS5901

Nominal Working Voltage (Ue) : 440V

Nominal Insulation Voltage (Ui) : 690V

Maximum Tightening Torque : 14Nm

Related Parts : **SH8...H**

See Page 5

Pt. No.	Height H-mm	Thread Size	Thread Depth D-mm
SH830	30	M8	9
* SH835	35	M8	10
* SH840	40	M8	10
* SH845	45	M8	10
* SH850	50	M8	10
* SH860	60	M8	10

SH880	80	M8	10
SH8100	100	M8	10

Please contact our Technical Department for availability of these,
or any other, non-standard insulators.

* Also available in Low Smoke material, see Page14 for more information

See Pages 24 - 26
for Technical Data

SHATTERPROOF HEXAGONAL

25 to 50mm HIGH

M6 THREADS

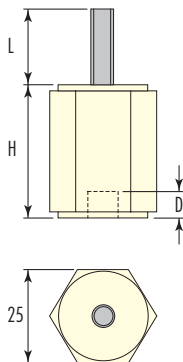

Pt. No.	Height H-mm	Thread Size	Thread Depth D-mm	Thread Length L-mm
SH625H	25	M6	7	20
SH630H	30	M6	7	20
SH635H	35	M6	7	20
SH640H	40	M6	7	20
SH645H	45	M6	7	20
SH650H	50	M6	7	20

Base Material : Glass Fibre Reinforced Polyester DMC
with High Arc Resistance and
Reduced Flammability

Colour : Beige

Working Temperature : 160 °C

Oxygen Index : 30% to ISO 4589

UL Approval : UL94 - V0

Insert Material : Female - Brass
Male - Mild Steel Zinc &
Passivate

Thread : Isometric medium fit coarse thread
class 6H/6g

CTI : > 600V to BS5901

Nominal Working Voltage (Ue) : 440V

Nominal Insulation Voltage (Ui) : 690V

Maximum Tightening Torque : 4.5Nm

Related Parts : **SH6...**

See Page 2

Non standard sizes are also
available. Please contact our
Technical Department for details.

See Pages 24 - 26
for Technical Data

INSULATORS 'SH' TYPE

SHATTERPROOF HEXAGONAL

25 to 50mm HIGH

M8 THREADS

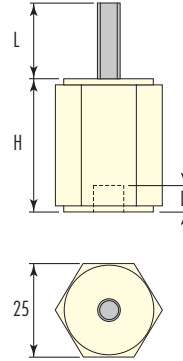

Base Material : Glass Fibre Reinforced Polyester DMC
with High Arc Resistance and
Reduced Flammability

Colour : Beige

Working Temperature : 160 °C

Oxygen Index : 30% to ISO 4589

UL Approval : UL94 - VO

Insert Material : Female - Brass
Male - Mild Steel Zinc &
Passivate

Thread : Isometric medium fit coarse thread
class 6H/6g

CTI : > 600V to BS5901

Nominal Working Voltage (Ue) : 440V

Nominal Insulation Voltage (Ui) : 690V

Maximum Tightening Torque : 14Nm

Related Parts : SH8...

See Page 3

Pt. No.	Height H-mm	Thread Size	Thread Depth D-mm	Thread Length L-mm
SH825H	25	M8	10	20
SH825H28	25	M8	10	28
SH830H	30	M8	10	20
SH835H	35	M8	10	20
* SH835H28	35	M8	10	28
SH840H	40	M8	10	20
* SH840H28	40	M8	10	28
SH845H	45	M8	10	20
SH850H	50	M8	10	20

* Also available in Low Smoke material, see Page 14 for more information

See Pages 24 - 26
for Technical Data

Non standard sizes are also
available. Please contact our
Technical Department for details.

SHATTERPROOF ROUND

35 to 50mm HIGH

M8 THREADS

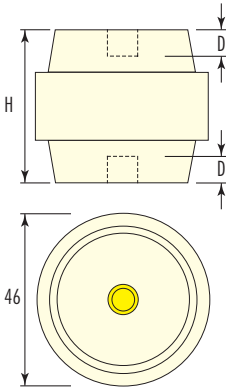

INSULATORS 'SO' TYPE



Base Material : Glass Fibre Reinforced Polyester DMC
with High Arc Resistance and
Reduced Flammability

Colour : Beige

Working Temperature : 160 °C

Oxygen Index : 30% to ISO 4589

UL Approval : UL94 - V0

Insert Material : Female - Brass

Thread : Isometric medium fit coarse thread
class 6H/6g

CTI : > 600V to BS5901

Nominal Working Voltage (Ue) : 440V

Nominal Insulation Voltage (Ui) : 690V

Maximum Tightening Torque : 17Nm

Related Parts : **S08..H**

See Page 8

Pt. No.	Height H-mm	Thread Size	Thread Depth D-mm
* S0835	35	M8	10
S0840	40	M8	10
S0845	45	M8	10
* S0850	50	M8	10

* Also available in Low Smoke material, see Page 14 for more information

See Pages 24 - 26
for Technical Data

INSULATORS 'SO' TYPE

SHATTERPROOF ROUND

35 to 50mm HIGH

M10 THREADS

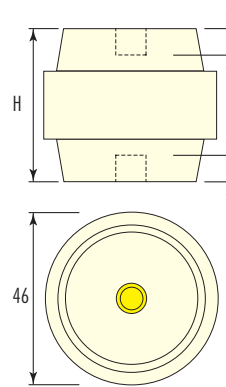

Base Material : Glass Fibre Reinforced Polyester DMC
with High Arc Resistance and
Reduced Flammability

Colour : Beige

Working Temperature : 160°C

Oxygen Index : 30% to ISO 4589

UL Approval : UL94 - V0

Insert Material : Female - Brass

Thread : Isometric medium fit coarse thread
class 6H/6g

CTI : >600V to BS5901

Nominal Working Voltage (Ue) : 440V

Nominal Insulation Voltage (Ui) : 690V

Maximum Tightening Torque : 33Nm

Pt. No.	Height H-mm	Thread Size	Thread Depth D-mm
* SO1035	35	M10	10
SO1040	40	M10	10
* SO1045	45	M10	10
SO1050	50	M10	10

* Also available in Low Smoke material, see Page 14 for more information

See Pages 24 - 26
for Technical Data

SHATTERPROOF ROUND

35 to 50mm HIGH

M8 THREADS

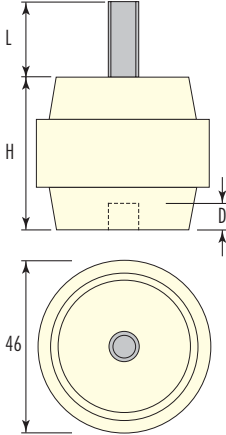

INSULATORS 'SO' TYPE



Pt. No.	Height H-mm	Thread Size	Thread Depth D-mm	Thread Length L-mm
SO835H	35	M8	10	20
SO840H	40	M8	10	20
SO845H	45	M8	10	20
SO850H	50	M8	10	20

Base Material : Glass Fibre Reinforced Polyester DMC
with High Arc Resistance and
Reduced Flammability

Colour : Beige

Working Temperature : 160 °C

Oxygen Index : 30% to ISO 4589

UL Approval : UL94 - V0

Insert Material : Female - Brass
Male - Mild Steel Zinc &
Passivate

Thread : Isometric medium fit coarse thread
class 6H/6g

CTI : > 600V to BS5901

Nominal Working Voltage (Ue) : 440V

Nominal Insulation Voltage (Ui) : 690V

Maximum Tightening Torque : 17Nm

Related Parts : **SO8..**

See Page 6

See Pages 24 - 26
for Technical Data

NON-STANDARD TYPE

SHATTERPROOF N/S

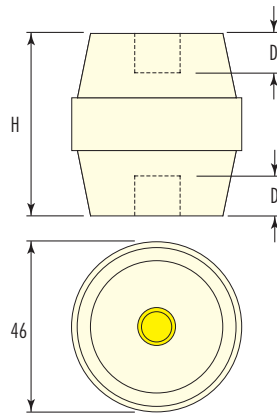

Base Material : Glass Fibre Reinforced Polyester DMC
with High Arc Resistance and
Reduced Flammability

Colour : Beige

Working Temperature : 160 °C

Oxygen Index : 30% to ISO 4589

UL Approval : UL94 - VO

Insert Material : Female - Brass

Thread : Isometric medium fit coarse thread
class 6H/6g

CTI : >600V to BS5901

Nominal Working Voltage (Ue) : 440V

Nominal Insulation Voltage (Ui) : 690V

Maximum Tightening Torque : **3635** - 7Nm
3847 - 17Nm
31047 - 33Nm

Pt. No.	Height H-mm	Thread Size	Thread Depth D-mm
* 3635	35	M6	10
* 3847	48	M8	10
* 31047	48	M10	16

* Also available in Low Smoke material, see Page 15 for more information

See Pages 24 - 26
for Technical Data

Please contact our Sales Department should
you require any other Non-Standard parts

SHATTERPROOF

51mm HIGH

M8, M10 & M12 THREADS

INSULATORS 'S' TYPE

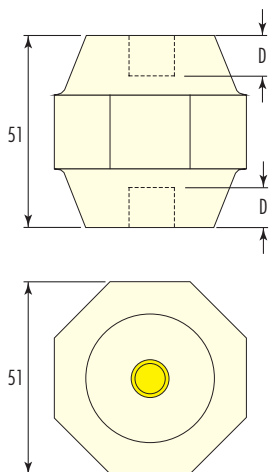

Pt. No.	Thread Size	Thread Depth D-mm
* 3850	M8	10
* 31050	M10	16
* 31250	M12	16

* Also available in Low Smoke material, see Page 15 for more information

Base Material : Glass Fibre Reinforced Polyester DMC with High Arc Resistance and Reduced Flammability

Colour : Beige

Working Temperature : 160 °C

Oxygen Index : 30% to ISO 4589

UL Approval : UL94 - V0

Insert Material : Female - Brass

Thread : Isometric medium fit coarse thread class 6H/6g

CTI : > 600V to BS5901

Nominal Working Voltage (Ue) : 440V

Nominal Insulation Voltage (Ui) : 690V

Maximum Tightening Torque : **3850** - 17Nm
31050 - 33Nm
31250 - 40Nm

See Pages 24 - 26
for Technical Data

INSULATORS 'S' TYPE

SHATTERPROOF

60mm HIGH

M8, M10, M12 & M16 THREADS



Base Material : Glass Fibre Reinforced Polyester DMC
with High Arc Resistance and
Reduced Flammability

Colour : Beige

Working Temperature : 160 °C

Oxygen Index : 30% to ISO 4589

UL Approval : UL94 - V0

Insert Material : Female - Brass

Thread : Isometric medium fit coarse thread
class 6H/6g

CTI : > 600V to BS5901

Nominal Working Voltage (Ue) : 440V

Nominal Insulation Voltage (Ui) : 690V

Maximum Tightening Torque : **3860** - 17Nm
31060 - 33Nm
31260 - 57Nm
31660 - 95Nm

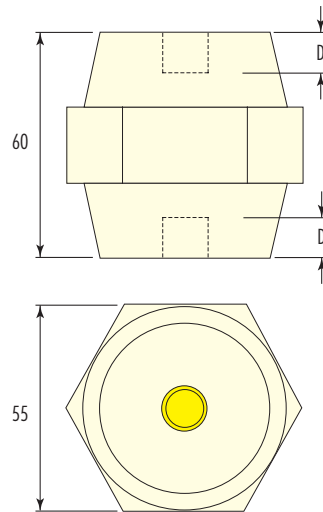

Pt. No.	Thread Size	Thread Depth D-mm
* 3860	M8	10
* 31060	M10	16
* 31260	M12	16
* 31660	M16	22

* Also available in Low Smoke material, see Page 15 for more information

See Pages 24 - 26
for Technical Data

SHATTERPROOF

60mm HIGH

M12 & M16 MALE THREADS

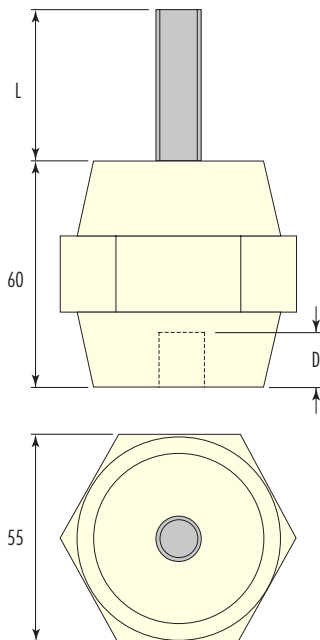

	Female Thread Size	Male Thread Size	Female Thread Depth D	Male Thread Length L
* 31060M12	M10	M12	16	40
31660M16	M16	M16	22	40

* Female version also available in Low Smoke material, see Page 15 for more information

See Pages 24 - 26 for Technical Data

INSULATORS 'S' TYPE



Base Material : Glass Fibre Reinforced Polyester DMC with High Arc Resistance and Reduced Flammability

Colour : Beige

Working Temperature : 160 °C

Oxygen Index : 30% to ISO 4589

UL Approval : UL94 - V0

Insert Material : Female - Brass
Male - Mild Steel Zinc & Passivate

Thread : Isometric medium fit coarse thread class 6H/6g

CTI : > 600V to BS5901

Nominal Working Voltage (Ue) : 440V

Nominal Insulation Voltage (Ui) : 690V

Maximum Tightening Torque : 31060M12 - 33Nm
31660M16 - 95Nm

INSULATORS 'S' TYPE

SHATTERPROOF

70mm HIGH

M8, M10 & M12 THREADS



Base Material : Glass Fibre Reinforced Polyester DMC
with High Arc Resistance and
Reduced Flammability

Colour : Beige

Working Temperature : 160 °C

Oxygen Index : 30% to ISO 4589

UL Approval : UL94 - VO

Insert Material : Female - Brass

Thread : Isometric medium fit coarse thread
class 6H/6g

CTI : > 600V to BS5901

Nominal Working Voltage (Ue) : 440V

Nominal Insulation Voltage (Ui) : 690V

Maximum Tightening Torque : **3870** - 17Nm
31070 - 33Nm
31270 - 57Nm

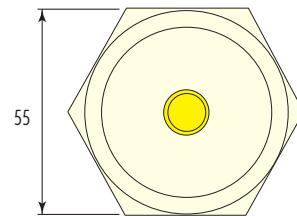
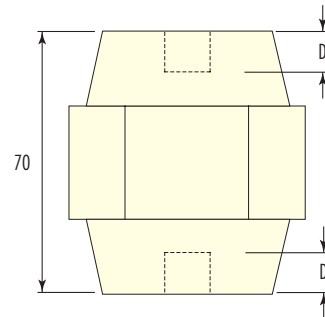

Pt. No.	Thread Size	Thread Depth D-mm
* 3870	M8	10
* 31070	M10	16
* 31270	M12	16

* Also available in Low Smoke material, see Page 15 for more information

See Pages 24 - 26
for Technical Data











LOW SMOKE

25 to 70mm HIGH

NFF16-101/102 COMPLIANT

INSULATORS 'L' TYPE

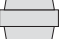
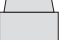
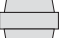

	Part No.	Thread Size	Page No. for Dimensions	Tightening Torques
	LSH625	M6	2	7Nm
	LSH835	M8	3	14Nm
	LSH840	M8	3	14Nm
	LSH850	M8	3	14Nm
	LSH860	M8	3	14Nm
	LSH835H28	M8	5	14Nm
	LSH840H28	M8	5	14Nm
				
	L3835	M8	6	17Nm
	LS0850	M8	6	17Nm
	L31035	M10	7	33Nm
	LS01045	M10	7	33Nm
				

See Pages 24 - 26
for Technical Data

Base Material : Glass Fibre Reinforced Polyester DMC
with High Fire Retardancy and
Low Smoke Emission

Colour : Grey

Working Temperature : 160 °C

Oxygen Index : >70% to ISO4589

Fire Approval : NFF101/102 IO,F1

Insert Material : Female - Brass
Male - Mild Steel Zinc &
Passivate

Thread : Isometric medium fit coarse thread
class 6H/6g

CTI : > 600V to IEC112

Nominal Working Voltage (Ue) : 440V

Nominal Insulation Voltage (Ui) : 690V

INSULATOR 'L' TYPE

LOW SMOKE

25 to 70mm HIGH

NFF16-101/102 COMPLIANT



Base Material : Glass Fibre Reinforced Polyester DMC with High Fire Retardancy and Low Smoke Emission

Colour : Grey

Working Temperature : 160 °C

Oxygen Index : > 70% to ISO4589

Fire Approval : NFF101/102 IO,F1

Insert Material : Female - Brass
Male - Mild Steel Zinc & Passivate

Thread : Isometric medium fit coarse thread class 6H/6g

CTI : > 600V to IEC112

Nominal Working Voltage (Ue) : 440V

Nominal Insulation Voltage (Ui) : 690V

Part No.	Thread Size	Page No. for Dimensions	Tightening Torques
----------	-------------	-------------------------	--------------------



L3635

M6

9

7Nm



L3847

M8

9

17Nm

L31047

M10

9

33Nm



L3850

M8

10

17Nm

L31050

M10

10

33Nm

L31250

M12

10

40Nm



L3860

M8

11

17Nm

L31060

M10

11

33Nm

L31260

M12

11

57Nm

L31660

M16

11

95Nm



L31060M12

M10 (f)

12

33Nm

M12 (m)



L3870

M8

13

17Nm

L31070

M10

13

33Nm

L31270

M12

13

57Nm



See Pages 24 - 26
for Technical Data

PILLAR INSULATORS

'F' TYPE

20 to 30mm HIGH

M4 THREADS

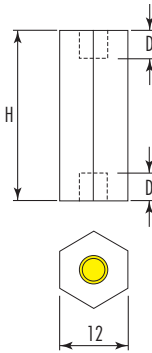

Pt. No.	Height H-mm	Thread Size	Thread Depth D-mm
3M420F	20	M4	5
3M425F	25	M4	5
3M430F	30	M4	5

Base Material : Polyamide 6 with Low Smoke
Emission and Flame Retardant

Colour : White

Working Temperature : 80 -110 °C (long term)
150 °C (short term)

Oxygen Index : 34% to ASTM D 2863

UL Approval : UL94 - V0

Fire Approval : NFF16-101/102 I2/F3

Insert Material : Female - Brass

Thread : Isometric medium fit coarse thread
class 6H/6g

CTI : > 600V to DIN53480

Nominal Working Voltage (Ue) : 440V

Nominal Insulation Voltage (Ui) : 690V

Maximum Tightening Torque : 2.0Nm

Related Parts : **3M4..H** / **3M4..M** See Pages 18 & 20

See Pages 24 - 26
for Technical Data

'F' TYPE



PILLAR INSULATORS

20 to 60mm HIGH

M5 THREADS

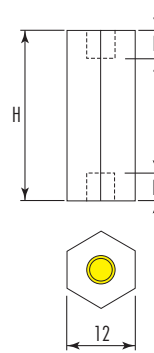

Base Material : Polyamide 6 with Low Smoke Emissions and Flame Retardant

Colour : White

Working Temperature : 80 -110 °C (long term)
150 °C (short term)

Oxygen Index : 34% to ASTM D 2863

UL Approval : UL94 - VO

Fire Approval : NFF16-101/102 I2/F3

Insert Material : Female - Brass

Thread : Isometric medium fit coarse thread
class 6H/6g

CTI : > 600V to DIN53480

Nominal Working Voltage (Ue) : 440V

Nominal Insulation Voltage (Ui) : 690V

Maximum Tightening Torque : 4.0Nm

Related Parts : **3M5..H** / **3M5..M** See Pages 19 & 21

Pt. No.	Height H-mm	Thread Size	Thread Depth D-mm
3M520F	20	M5	5
3M525F	25	M5	5
3M530F	30	M5	5
3M540F	40	M5	5
3M550F	50	M5	5
3M560F	60	M5	5

See Pages 24 - 26
for Technical Data

PILLAR INSULATORS

'H' TYPE

15 to 30mm HIGH

M4 THREADS

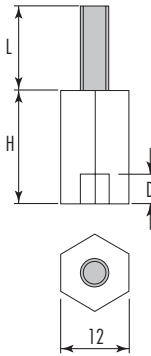

Pt. No.	Height H-mm	Thread Size	Thread Depth D-mm	Thread Length L-mm
3M415H	15	M4	5	16
3M420H	20	M4	5	16
3M425H	25	M4	5	16
3M430H	30	M4	5	16

Base Material : Polyamide 6 with Low Smoke Emissions and Flame Retardant
Colour : White

Working Temperature : 80 -110 °C (long term)
150 °C (short term)

Oxygen Index : 34% to ASTM D 2863

UL Approval : UL94 - V0

Fire Approval : NFF16-101/102 12/F3

Insert Material : Female - Brass
Male - Mild Steel Zinc & Passivate

Thread : Isometric medium fit coarse thread
class 6H/6g

CTI : > 600V to DIN53480

Nominal Working Voltage (Ue) : 440V

Nominal Insulation Voltage (Ui) : 690V

Maximum Tightening Torque : 2.0Nm

Related Parts : **3M4..F / SM4..M** See Pages 16 & 20

See Pages 24 - 26
for Technical Data

'H' TYPE



PILLAR INSULATORS

15 to 60mm HIGH

M5 THREADS

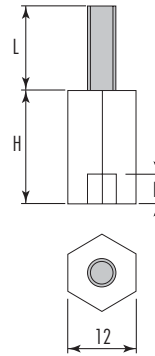

Base Material : Polyamide 6 with Low Smoke Emissions and Flame Retardant

Colour : White

Working Temperature : 80 -110 °C (long term)
150 °C (short term)

Oxygen Index : 34% to ASTM D 2863

UL Approval : UL94 - VO

Fire Approval : NFF16-101/102 I2/F3

Insert Material : Female - Brass
Male - Mild Steel Zinc & Passivate

Thread : Isometric medium fit coarse thread class 6H/6g

CTI : > 600V to DIN53480

Nominal Working Voltage (Ue) : 440V

Nominal Insulation Voltage (Ui) : 690V

Maximum Tightening Torque : 4.0Nm

Related Parts : **3M5..F** / **3M5..M** See Pages 17 & 21

Pt. No.	Height H-mm	Thread Size	Thread Depth D-mm	Thread Length L-mm
3M515H	15	M5	5	14
3M520H	20	M5	5	14
3M525H	25	M5	5	14
3M530H	30	M5	5	14
3M540H	40	M5	5	14
3M550H	50	M5	5	14
3M560H	60	M5	5	14

See Pages 24 - 26
for Technical Data

PILLAR INSULATORS

'M' TYPE

15 to 30mm HIGH

M4 THREADS

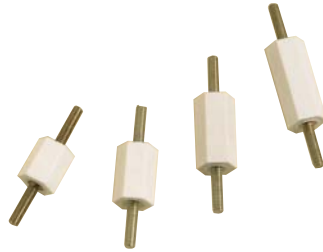
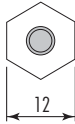
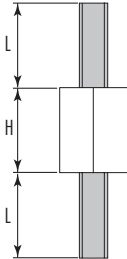

Pt. No.	Height H-mm	Thread Size	Thread Length L-mm
3M415M	15	M4	16
3M420M	20	M4	16
3M425M	25	M4	16
3M430M	30	M4	16

Base Material : Polyamide 6 with Low Smoke Emissions and Flame Retardant

Colour : White

Working Temperature : 80 -110 °C (long term)
150 °C (short term)

Oxygen Index : 34% to ASTM D 2863

UL Approval : UL94 - V0

Fire Approval : NFF16-101/102 I2/F3

Insert Material : Male - Mild Steel Zinc & Passivate

Thread : Isometric medium fit coarse thread
class 6H/6g

CTI : > 600V to DIN53480

Nominal Working Voltage (Ue) : 440V

Nominal Insulation Voltage (Ui) : 690V

Maximum Tightening Torque : 2.0Nm

Related Parts : **3M4..F** / **3M4..H** See Pages 16 & 18

See Pages 24 - 26
for Technical Data

'M' TYPE

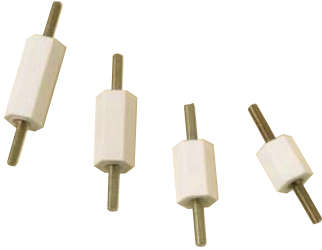

Base Material : Polyamide 6 with Low Smoke Emissions and Flame Retardant

Colour : White

Working Temperature : 80 -110 °C (long term)
150 °C (short term)

Oxygen Index : 34% to ASTM D 2863

UL Approval : UL94 - VO

Fire Approval : NFF16-101/102 I3/F2

Insert Material : Male - Mild Steel Zinc & Passivate

Thread : Isometric medium fit coarse thread class 6H/6g

CTI : > 600V to DIN53480

Nominal Working Voltage (Ue) : 440V

Nominal Insulation Voltage (Ui) : 690V

Maximum Tightening Torque : 4.0Nm

Related Parts : **3M5..F** / **3M5..H** See Pages 17 & 19

PILLAR INSULATORS

15 to 60mm HIGH

M5 THREADS

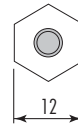
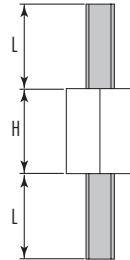

Pt. No.	Height H-mm	Thread Size	Thread Length L-mm
3M515M	15	M5	14
3M520M	20	M5	14
3M525M	25	M5	14
3M530M	30	M5	14
3M540M	40	M5	14
3M550M	50	M5	14
3M560M	60	M5	14

See Pages 24 - 26
for Technical Data

THERMOPLASTIC HEXAGON

CYGNUS INSULATOR

25 to 35mm HIGH

M6 or M8 THREADS

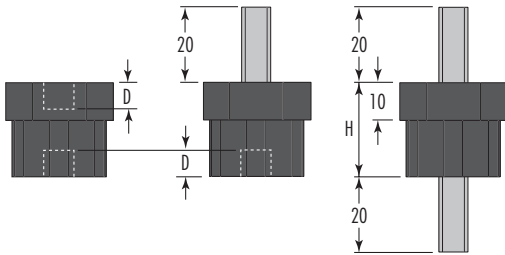

C2X...F

C2X...H

C2X...M



Pt. No.	Height H-mm	Thread Size	Thread Depth D-mm
C2X625F	25	M6	7
C2X630F	30	M6	7
C2X635F	35	M6	7
C2X830F	30	M8	9
C2X835F	35	M8	10
C2X625H	25	M6	7
C2X630H	30	M6	7
C2X635H	35	M6	7
C2X825H	25	M8	9
C2X830H	30	M8	10
C2X835H	35	M8	10
C2X625M	25	M6	
C2X630M	30	M6	
C2X635M	35	M6	
C2X830M	30	M8	
C2X835M	35	M8	

See Pages 24 - 26
for Technical Data

Base Material : Polyamide 6 with Low Smoke
Emissions and Flame Retardant

Colour : Black

Working Temperature : 100 °C

UL Approval : UL94 - V0

Fire Approval : NFF16-101/102 I3/F2

Insert Material : Female - Brass
Male - Mild Steel Zinc &
Passivate

Thread : Isometric medium fit coarse thread
class 6H/6g

CTI : 600V to DIN53480

Nominal Working Voltage (Ue) : 440V

Nominal Insulation Voltage (Ui) : 690V

Maximum Tightening Torque : F H & M
M6-7Nm M6-7Nm
M8-17Nm M8-14Nm

CYGNUS INSULATOR



THERMOPLASTIC HEXAGON

35 to 50mm HIGH

M6, M8 or M10 THREADS

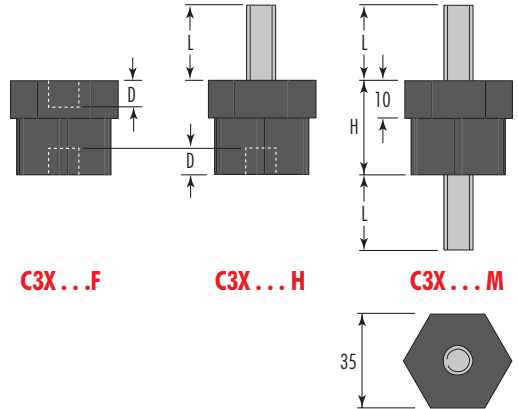

Pt. No.	H	Thread Size	D	Pt. No.	H	Thread Size	L	D	Pt. No.	H	Thread Size	L
C3X635F	35	M6	7	C3X635H	35	M6	20	7	C3X635M	35	M6	20
C3X640F	40	M6	7	C3X640H	40	M6	20	7	C3X640M	40	M6	20
C3X645F	45	M6	7	C3X645H	45	M6	20	7	C3X645M	45	M6	20
C3X650F	50	M6	7	C3X650H	50	M6	20	7	C3X650M	50	M6	20
C3X835F	35	M8	9	C3X835H	35	M8	20	9	C3X835M	35	M8	20
C3X840F	40	M8	9	C3X840H	40	M8	20	9	C3X840M	40	M8	20
C3X845F	45	M8	9	C3X845H	45	M8	20	9	C3X845M	45	M8	20
C3X850F	50	M8	9	C3X850H	50	M8	20	9	C3X850M	50	M8	20
C3X1035F	35	M10	10	C3X1035H	35	M10	34	10	C3X1035M	35	M10	34
C3X1040F	40	M10	10	C3X1040H	40	M10	34	10	C3X1040M	40	M10	34
C3X1045F	45	M10	10	C3X1045H	45	M10	34	10	C3X1045M	45	M10	34
C3X1050F	50	M10	10	C3X1050H	50	M10	34	10	C3X1050M	50	M10	34

Maximum Tightening Torque :

Type F - M6 - 7Nm Types H & M - M6 - 7Nm
 M8 - 17Nm M8 - 14Nm
 M10 - 33Nm M10 - 30Nm

All other Technical Information as Page 22

See Page 24
for Technical Data

For further details please contact
our Technical Department

TECHNICAL DATA

SH, SO & S

PHYSICAL PROPERTIES

Material : Zero Halogen & Phosphorous Free Glass fibre reinforced Polyester DMC with high arc resistance and reduced flammability.

Colour : Beige

Working Temperature : 160 °C

Oxygen Index : 30% to BS2782 method 141 ISO 4589

Flammability : VO rated or equivalent

MECHANICAL PROPERTIES

Tensile Strength : 400kgf/cm² to BS2782 method 320E

Flexural Modulus : 9500kgf/cm² to BS2782 method 335A

Charpy Impact Strength (notched) : 20kj/m² to BS2782 method 359

ELECTRICAL PROPERTIES

Electric Strength : 8MV/m at 90 °C to BS2782

Resistance to Tracking (CTI) : > 600V to BS5901

INSERT MATERIAL

Female : Brass

Male : Mild Steel Zinc & Passivate (ROSH compliant)

LOW SMOKE

PHYSICAL PROPERTIES

Material : Zero Halogen & Phosphorous Free Glass fibre reinforced Polyester DMC with high fire retardancy & low smoke emissions.

Colour : Grey

Working Temperature : 160 °C

Oxygen Index : 70% to BS2782 method 141 ISO4589

Approval : NFF101/102 IO/F1

UL Approval : UL94 - VO

MECHANICAL PROPERTIES

Tensile Strength : 30MPa BS2782 method 320E ISO527

Flexural Strength : 80MPa BS2782 method 335A ISO178-75

Flexural Modulus : 9.0GPa BS2782 method 335A ISO178-75

ELECTRICAL PROPERTIES

Electric Strength : 9MV/m at 90 °C BS2782 method 220 ISO243

Resistance to Tracking (CTI) : > 600V to BS5901 IEC112

INSERT MATERIAL

Female : Brass

Male : Mild Steel Zinc & Passivate (ROSH compliant)

PILLARS

PHYSICAL PROPERTIES

Material : Zero Halogen & Phosphorous Free Polyamide 6 with Low Smoke Emissions and Flame Retardant

Colour : White

Working Temperature : 80-110 °C (Long Term)
150 °C (Short Term)

Oxygen Index : 34% to ASTM D 2863

UL Approval : UL94 - VO

Fire Approval : NFF16-101/102 I2/F3

MECHANICAL PROPERTIES

Tensile Strength (Cond.) : 40N/mm² to DIN 53455

Flexural E Modulus : 1000N/mm² to DIN 53452

Charpy Impact Strength (notched) : 20kj/m² to DIN53453

ELECTRICAL PROPERTIES

Dielectrical Strength : 35kV/mm to DIN53481

Resistance to Tracking (CTI) : > 600V to DIN53480

INSERT MATERIAL

Female : Brass

Male : Mild Steel Zinc & Passivate (ROSH compliant)

CYGNUS

PHYSICAL PROPERTIES

Material : Polyamide 6 30% Glass filled

Colour : Black

Working Temperature : 100 ° continuous

Oxygen Index : 21.3% ISO4589

UL Approval : UL94 - VO

MECHANICAL PROPERTIES

Tensile Strength : 190 MPa (dry) DIM 53456

ELECTRICAL PROPERTIES

Dielectric Strength : 13MV/m BS2782

Resistance to Tracking (CTI) : 550V IEC112

INSERT MATERIAL

Female : Brass

10kV INSULATOR

PHYSICAL PROPERTIES

Material : Cast Epoxy Resin

Colour : Brown

Working Temperature : 20 °C to 75 °C

Oxygen Index : > 80% to ISO4589

MECHANICAL PROPERTIES

Tensile Strength : 80N/mm² to DIN53455/3

Impact Strength (notched) : 2.2kj/m² to DIN53453

ELECTRICAL PROPERTIES

Dielectric Constant : 3.3 to VDE 0303T4

Resistance to Tracking (CTI) : 600V to IEC112

INSERT MATERIAL

Female : Brass

TECHNICAL DATA

Part No.	Minimum Creepage Distance mm	Impulse Voltage U_{imp} kV	Flashover Voltage kV
SH625	25	17	19
SH630	30	19	21
SH635	35	20	23
SH640	40	22	24
SH645	45	23	25
SH650	50	24	26
SH660	60	26	28
SH680	80	28	> 30
SH6100	100	30	> 30
SH830	30	19	21
SH835	35	20	23
SH840	40	22	24
SH845	45	23	25
SH850	50	24	26
SH860	60	26	28
SH880	80	28	> 30
SH8100	100	30	> 30
SH625H	25	17	19
SH630H	30	19	21
SH635H	35	20	23
SH640H	40	22	24
SH645H	45	23	25
SH650H	50	24	26
SH825H	25	17	19
SH830H	30	19	21
SH835H	35	20	23
SH840H	40	22	24
SH845H	45	23	25
SH850H	50	24	26
S0835	37	23	26
S0840	42	24	27
S0845	47	26	29
S0850	52	28	30
S01035	37	23	26
S01040	42	24	27
S01045	47	26	29
S01050	52	28	30
S0835H	37	23	26
S0840H	42	24	27
S0845H	47	26	29
S0850H	52	28	30

Part No.	Minimum Creepage Distance mm	Impulse Voltage U_{imp} kV	Flashover Voltage kV
3635	37	25	27
3847	50	27	29
31047	50	27	29
3850	57	30	> 30
31050	57	30	> 30
31250	57	30	> 30
3860	63	30	> 30
31060	63	30	> 30
31260	63	30	> 30
31660	63	30	> 30
31060M12	63	30	> 30
31660M16	63	30	> 30
3870	73	30	> 30
31070	73	30	> 30
31270	73	30	> 30
L3635	37	27	29
L3835	37	27	29
L3847	50	28	29
L31047	50	28	29
L3850	57	30	> 30
L31050	57	30	> 30
L31250	57	30	> 30
L3860	63	30	> 30
L31060	63	30	> 30
L31260	63	30	> 30
L31660	63	30	> 30
L31060M12	63	30	> 30
L3870	73	30	> 30
L31070	73	30	> 30
L31270	73	30	> 30

CYGNUS

Minimum creepage distance is equivalent to the overall height.

TECHNICAL DATA continued

Part No.	Minimum Creepage Distance mm	Impulse Voltage U_{imp} kV	Flashover Voltage kV
3M420F	20	15	17
3M425F	25	19	21
3M430F	30	21	23
3M520F	20	15	17
3M525F	25	19	21
3M530F	30	21	23
3M540F	40	22	24
3M550F	50	24	26
3M560F	60	25	28
3M415H	15	13	15
3M420H	20	15	17
3M425H	25	19	21
3M430H	30	21	23
3M515H	15	13	15
3M520H	20	15	17
3M525H	25	19	21
3M530H	30	21	23
3M540H	40	22	24
3M550H	50	24	26
3M560H	60	25	28
3M415M	15	13	15
3M420M	20	15	17
3M425M	25	19	21
3M430M	30	21	23
3M515M	15	13	16
3M520M	20	15	17
3M525M	25	19	21
3M530M	30	21	23
3M540M	40	22	24
3M550M	50	24	26
3M560M	60	25	28

The test on S0835 (3835) was made using 32 x 6.3mm copper bars on a triple pole system at 22.4kA for 0.2 sec with each set of insulators being spaced as shown below, 400mm apart.

Part No. 3847 was tested in conjunction with Part No. 3514BI minor bushings at 173mm centres.

TESTED ARRANGEMENT

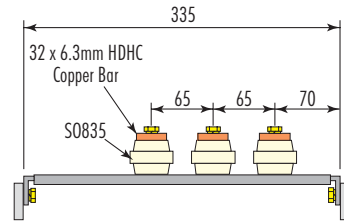

For additional information please contact our Technical Department

Ter-mate Part No.	3 Phase Fault Level	Fault Level Duration	Support Centres
S0835 3847 + 3514BI	22.4kA 10kA	0.2 sec 0.2 sec	400mm 173mm

TIGHTENING TORQUES

Further information for each specific insulator is available from our Technical Department.

We reserve the right to modify designs and specifications so as to permit the incorporation of technical developments.
Full technical support and back-up is available from Ter-mate Limited as required.

10kV INSULATOR



Base Material : Cast Epoxy Resin

Colour : Brown

Working Temperature : -20°C to 75°C

Insert Material : Female - Brass

Thread : Isometric medium fit coarse thread
class 6H/6g

CTI : > 600V to IEC112

Maximum Tightening Torque : 32Nm

CAST EPOXY RESIN

95mm HIGH

M10 & M16 THREADS

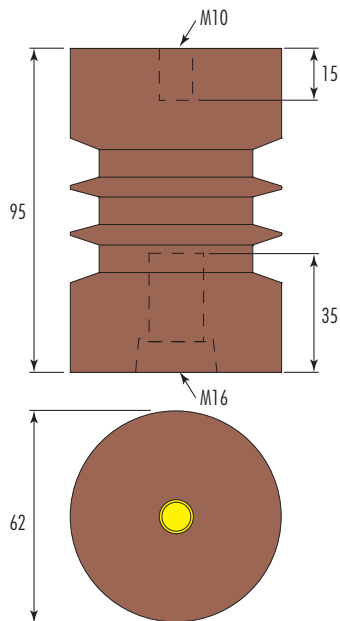

31695/10

See Page 24
for Technical Data

For further details please contact
our Technical Department