

EXAMPLE UNDERSIDE VIEW  
(800A, 1000A)

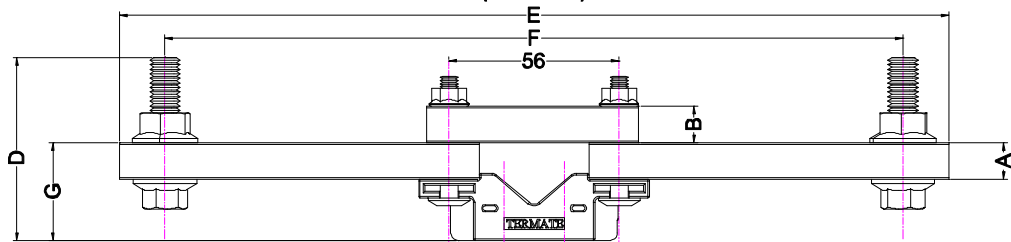

EXAMPLE OF TWIN BASE NEUTRAL  
LINK ASSEMBLIES  
(800A, 1000A)

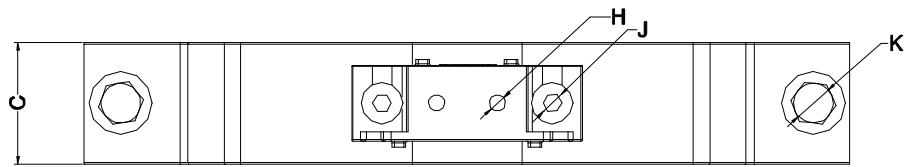

EXAMPLE UNDERSIDE VIEW  
(400A, 630A)

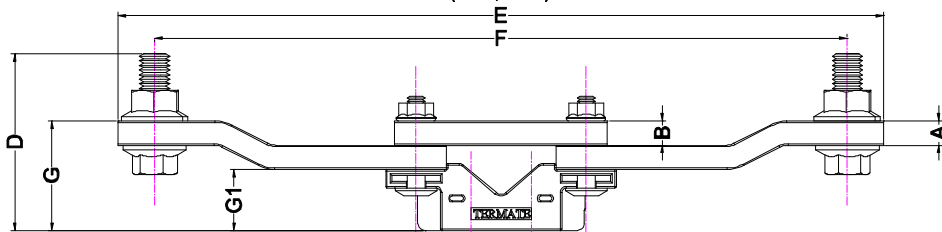

EXAMPLE OF SINGLE BASE TWIN LUG  
NEUTRAL LINK ASSEMBLIES  
(400A, 630A)

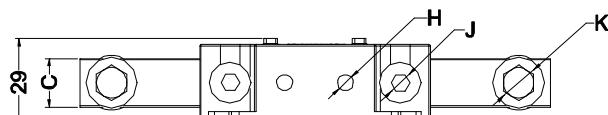

EXAMPLE UNDERSIDE VIEW  
(125A, 250A)

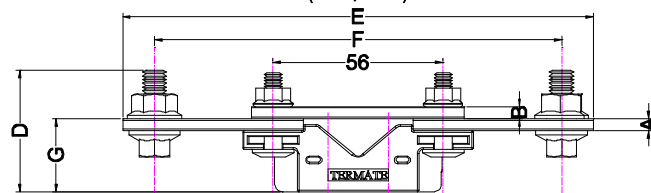

EXAMPLE OF SINGLE BASE NEUTRAL LINK  
ASSEMBLIES  
(125A, 250A)

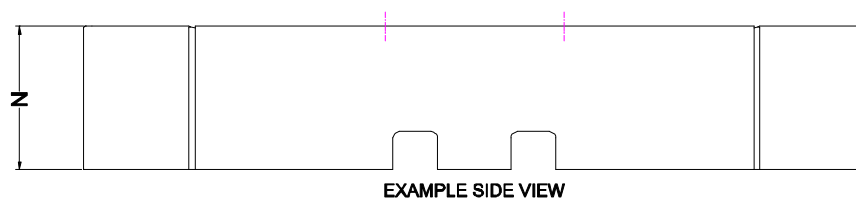
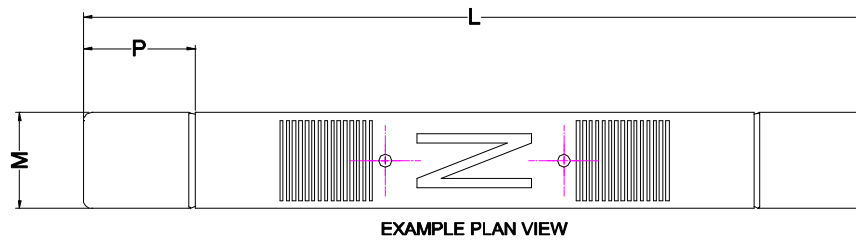

	A	B	C	D	E	F	G (G1)	H	J	K
TNL125	4	4	16	40	155	134	24	M5	M6	M8x20
TNL250	4	4	20	40	165	144	24	M5	M6	M8x20
TNL400	6	8	30	60	252	228	36 (20)	M5	M6	M10x25
TNL630	8	8	40	60	252	228	36 (20)	M5	M6	M10x25
TNL800	12	12	40	55	273	243	32	M5	M6	M10x40
TNL1000	12	12	50	60	273	243	32	M5	M6	M10x40

SHROUD	L	M	N	P	BOLT SIZE	MAXIMUM TIGHTENING TORQUE
TNL250CV	245	30	45	35	M5	4Nm
TNL630CV	440	45	70	85	M6	6Nm
TNL1000CV	440	60	70	80	M8	19Nm
					M10	32Nm

Conductor Material: Tin plated high conductivity copper  
 Support Material: Glass reinforced Polyamide 66, UL94 V0 rated  
 Cover Material: Polyamide 6, UL94 V0 rated  
 Rated Insulation Voltage (Ui): 690v  
 Rated Impulse Voltage (Uimp): 8kv peak

We reserve the right to modify designs and specifications to incorporate technical developments  
 For further information please contact Termate  
[sales@termate.com](mailto:sales@termate.com) telephone 0115 978 4652