

B⁴-30 & B⁴-50 Boot



In order to provide a greater degree of ingress protection, an insulating boot is available. When secured to the bushing with a cable tie, the boot affords a minimum of IP4X protection.



The boot is manufactured from flexible black flame retardant UL94-VO PVC material and can be readily cut to suit the user's requirements for cable connections.

CABLE SIZES	
B ⁴ -30	Each boot will accommodate up to 1 off 300mm ² or 2 off 240mm ² cables.
B ⁴ -50	Each boot will accommodate up to 1 off 500mm ² or 2 off 300mm ² cables.

B⁴-30

B⁴-50

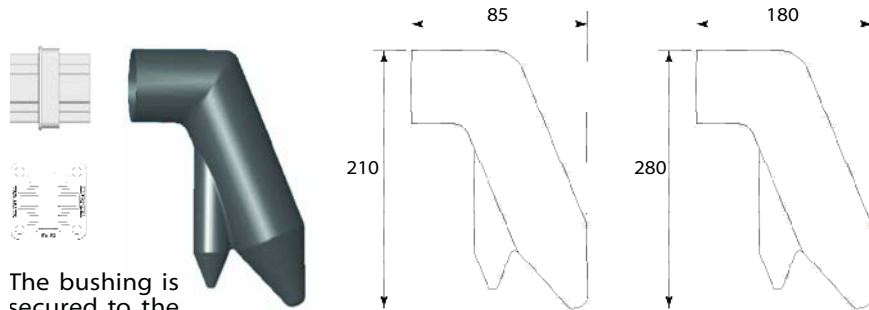

The bushing is secured to the boot using a cable tie.

TERMATE

Leone Works, John Street, New Basford, Nottingham. NG7 7HL

Tel: 0115 978 4652 Fax: 0115 970 2106

Email: sales@termate.com Website: www.termate.com

4-11/08

B⁴-30
B⁴-50

**Connector Bushings
and Boots**

TERMATE

B⁴-30



Ter-mate's B⁴-30 and B⁴-50 bushings have been designed to allow connections to pass through enclosure walls. This enables terminations to be made to switchgear or starter equipment whilst retaining Form 3 or Form 4 enclosure separation in full compliance with BSEN (IEC) 60439-1 when fitted with our specially designed insulated boot.

Moulded in-house from high grade black thermoplastic material with a UL94-V0 fire rating and has a dielectric performance rated insulation voltage of 690V. These bushings feature an innovative design enabling eight different sizes of conductor to be installed.

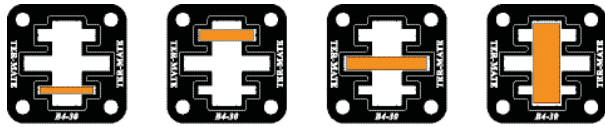

* B ⁴ -30 NOMINAL RATINGS				
COPPER SIZES	20 x 3	20 x 4	30 x 5	30 x 10
AMPS	220A	250A	400A	600A

* Nominal ratings depend on Enclosure, Design, Cables and Connections etc.

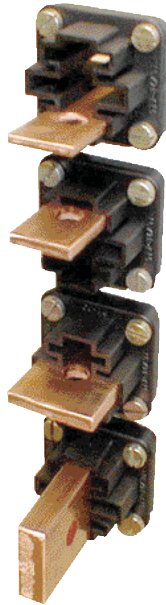

B⁴-50

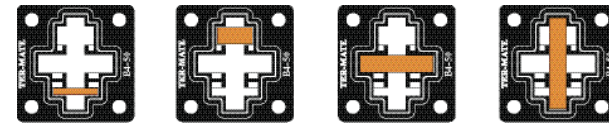

* B ⁴ -50 NOMINAL RATINGS				
COPPER SIZES	25 x 5	20 x 10	40 x 10	50 x 10
AMPS	350A	400A	700A	800A

* Nominal ratings depend on Enclosure, Design, Cables and Connections etc.

